

SP 5A

Performance curves

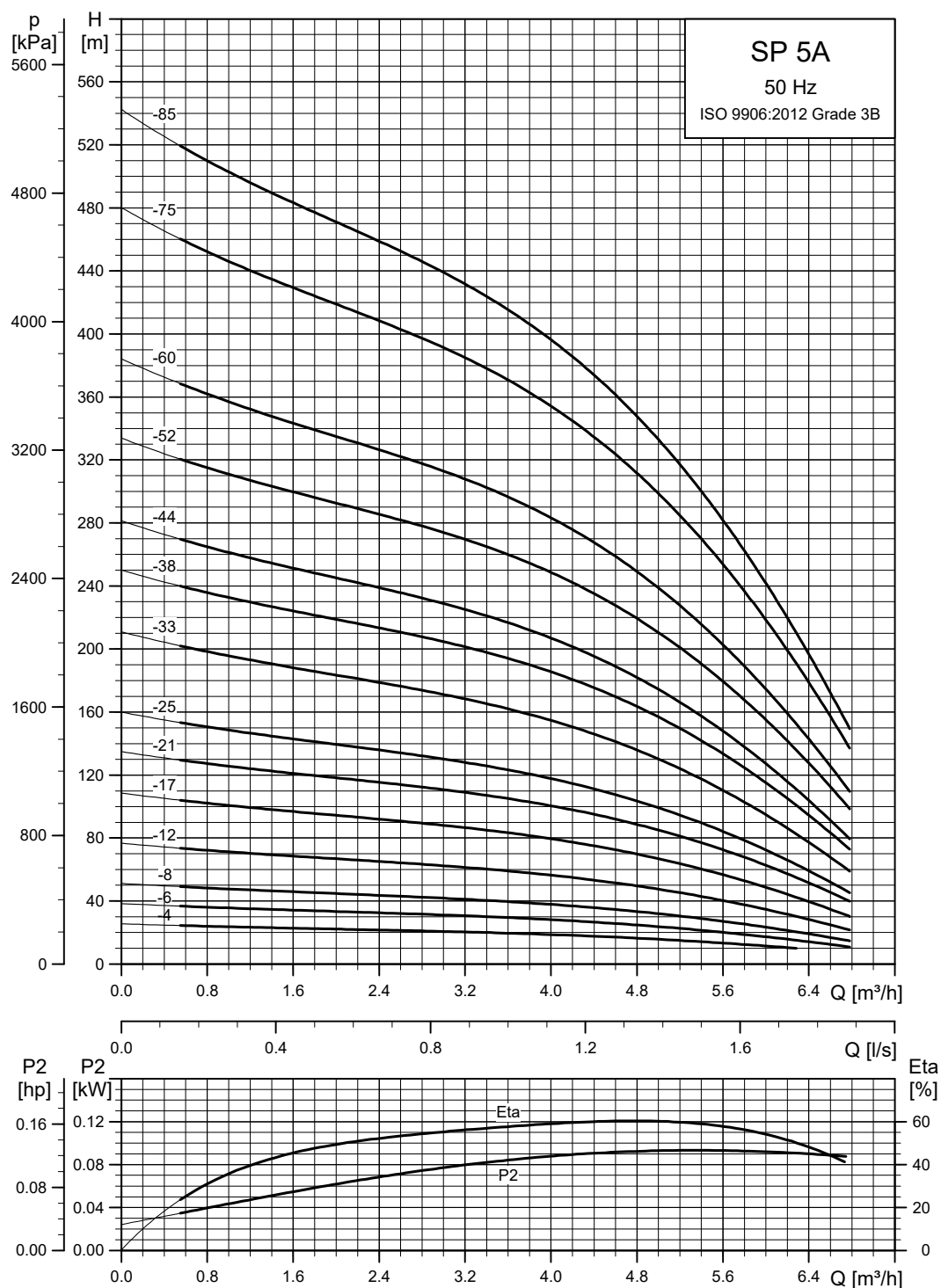

NPSH: Minimum inlet pressure 0.5 m.

Related information

[How to read the curve charts](#)

TM007274

Dimensions and weights

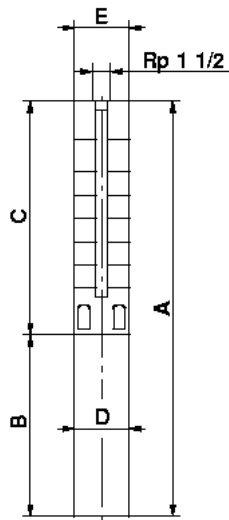

TM000956

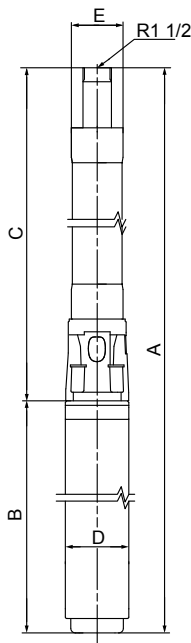

TM014202

Pump type	Motor		Dimensions [mm]					Net weight [kg]
	Type	Power [kW]	C	B	A	D	E	
Single-phase, 1 × 230 V								
SP 5A-4	MS 402	0.37	240	256	496	95	101	10
SP 5A-6	MS 402	0.55	282	276	558	95	101	11
SP 5A-8	MS 402	0.75	324	306	630	95	101	13
SP 5A-12	MS 402	1.1	408	346	754	95	101	15
SP 5A-17	MS 402	1.5	513	346	859	95	101	17
SP 5A-21	MS 4000	2.2	597	573	1170	95	101	27
SP 5A-25	MS 4000	2.2	681	573	1254	95	101	28
Three-phase, 3 × 230 V / 3 × 400 V								
SP 5A-4	MS 402	0.37	240	226	466	95	101	8
SP 5A-6	MS 402	0.55	282	241	523	95	101	10
SP 5A-8	MS 402	0.75	324	276	600	95	101	11
SP 5A-12	MS 402	1.1	408	306	714	95	101	13
SP 5A-17	MS 402	1.5	513	346	859	95	101	16
SP 5A-21	MS 402	2.2	597	346	943	95	101	18
SP 5A-25	MS 402	2.2	681	346	1027	95	101	19
SP 5A-33	MS 4000	3.0	849	493	1342	95	101	26
SP 5A-38	MS 4000	4.0	998	573	1571	95	101	36
SP 5A-44	MS 4000	4.0	1124	573	1697	95	101	38
SP 5A-52	MS 4000	5.5	1292	673	1965	95	101	46
SP 5A-60	MS 4000	5.5	1460	673	2133	95	101	48
SP 5A-52	MS 6000	5.5	1354	547	1901	139.5	139.5	60
SP 5A-60	MS 6000	5.5	1522	547	2069	139.5	139.5	63
SP 5A-75 ⁴⁾	MS 6000	7.5	2146	577	2723	139.5	139.5	86
SP 5A-85 ⁴⁾	MS 6000	7.5	2356	577	2933	139.5	139.5	92

SP 5A-4 up to SP 5A-33 are pumps with spline shaft as standard.
 SP 5A-34 up to SP 5A-85 are pumps with smooth shaft as standard.
 Pumps with spline shaft are only available in stainless steel EN 1.4301.
 Pumps with smooth shaft are also available in N (EN 1.4401) and R (EN 1.4539) version with MS4000R. See page 6.
 It is also possible to get the SP 5A-4 and up with smooth shaft.
 Pumps mounted in sleeve "SP5A-75 and up" are only available in standard and N-versions.
 E = Maximum diameter of pump inclusive of cable guard and motor.

Pump in sleeve

4) SP 5A-75 and SP 5A-85 are mounted in sleeve for R 1 1/2 connection and with a maximum diameter of 108 mm.